



# Accessories & General Equipment

## PVC Adapter Kit for Threaded to Solvent Weld Conversion

### Description

PVC Adaptor kit to convert both M BSPP Suction & Delivery Ports on various models of EMEC Prius Motor Driven pumps (EMEC PD) and EMEC Solenoid Driven Pumps (EMEC AMS & EMEC K) to Female Solvent Weld (includes another set of Nuts that are supplied with pump) - can be ordered as a 1 Pack (1PK) or 2 Pack (2PK).

Ordering Code	EMEC ADAPTKIT 1/2-15mm 2PK*	EMEC ADAPTKIT 3/4-15mm 2PK*	EMEC ADAPTKIT 3/8-15mm 2PK*
Compatible Pumps	EMEC PD 010 060 EMEC AMS 07 20	EMEC PD 005 240 EMEC PD 007 160 EMEC AMS 02 60 EMEC AMS 03 40	EMEC K series

\* To convert only 1 M BSPP port change this to 1PK



EMEC ADAPTKIT 1/2-15mm 1PK

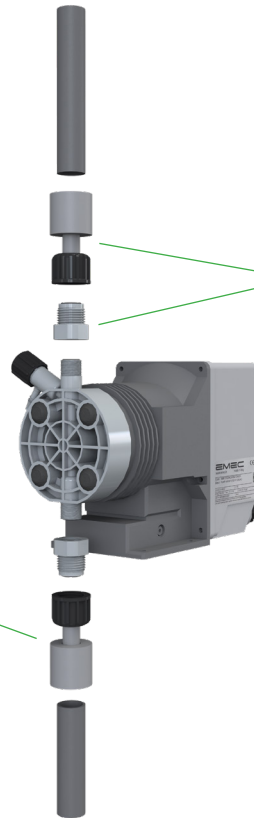

EMEC ADAPTKIT 3/8-15mm 1PK



EMEC ADAPTKIT 3/4-15mm 1PK



ver 2.0