



Accessories & Other Equipment

Conductivity (TDS) Probes



DCON-P10AT



DCON-P10ATT



DCON-P10ATS



DCON-P10DT



DCON-P10FS

Ordering Code	Description
DCON-P10AT	TDS probe, 1/4" flush carbon electrodes, 3/4" BSP thread
DCON-P10ATT	DCON-P10AT with threaded 3/4" BSP back for fitting into optional submersible probe holder, 5m moulded lead
DCON-P10ATS	TDS probe, 1/4" flush SS316 electrodes, 3/4" BSP thread
DCON-P10ATTS	DCON-P10ATS with threaded 3/4" BSP back for fitting into optional submersible probe holder, 5m moulded lead
DCON-P10DT	Low TDS probe, large carbon electrodes, 1" BSP thread
DCON-P10FS	Conductivity probe for monitoring boiler condensate return

Dimensional Drawings

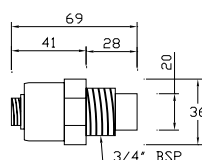

DCON-P10AT & DCON-P10ATS

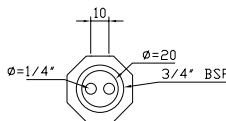

DCON-P10ATT & DCON-P10ATTS

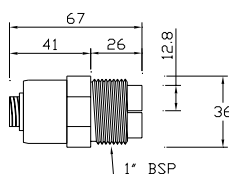
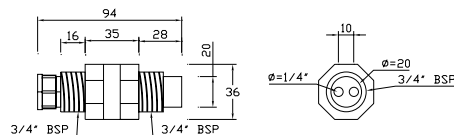

DCON-P10DT Probe

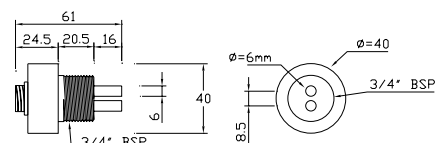

DCON-P10FS

Specifications

DCON-	P10AT	P10ATT	P10ATS	P10ATTS	P10DT	P10FS
Range	0-10,000 $\mu\text{S}/\text{cm}$				0-100 $\mu\text{S}/\text{cm}$	0-1000 $\mu\text{S}/\text{cm}$
Electrode material	Carbon		SS 316		Carbon	SS 316
Body material	PVC					PP
Max Pressure & Temp	750kPa (7.5bar) @ 40°C, 300kPa (3bar) @ 50°C					500kPa (5bar) @ 90°C
Thread	$\frac{3}{4}$ " M BSP				1" M BSP	$\frac{3}{4}$ " M BSP
Thread on back end for submersible mounting	-	$\frac{3}{4}$ " M BSP	-	$\frac{3}{4}$ " M BSP	-	-
Temp sensor	Thermistor internal 47k Ω @ 25°C					
Lead included	1.5 m	5 m	1.5 m	5 m	1.5 m	5 m
Conductors	Brown (PR+): electrode Yellow (PR-): electrode & thermistor (ie. common ground) Blue (CM+): thermistor					