



# Peristaltic & Metering Pumps

## SEKO Peristaltic PE & PR Series

Ordering Code	Description
<b>SEKO PE-0.4-FP</b>	Peristaltic Pump 0.4 litres/hr, 2.7 bar max
<b>SEKO PE-1.3-FP-T</b>	Peristaltic Pump 1.3 litres/hr, 2.7 bar max
<b>SEKO PE-5</b>	Peristaltic Pump 5.0 litres/hr, 1.5 bar max
<b>SEKO PR-1-FP</b>	Peristaltic Pump 0.3-1.0 litres/hr (adjustable), 2.7 bar max
<b>SEKO PR-4</b>	Peristaltic Pump 1.5-4.0 litres/hr (adjustable), 1.5 bar max
<b>SEKO PR-7</b>	Peristaltic Pump 3.0-7.0 litres/hr (adjustable), 1.5 bar max

**Note:** Add “-PLUG” onto end of code for power lead to be fitted with Australian mains plug.

## Description

SEKO Peristaltic pumps are ideal for most low pressure dosing applications where continuous dosing is not required. They are supplied complete with tubing, foot valve and injection valve, as well as a wall mounting bracket for simple installation.

These pumps are ideal for swimming pool and cooling tower dosing applications as well as for industrial washing and dishwashing machine dosing applications. As they are self-priming, they are ideal for dosing oxidising chemicals, such as Sodium Hypochlorite.

## Features & Benefits

- Polypropylene housing - shockproof & resistant to chemical aggression
- Easy maintenance - takes seconds to replace squeeze tube
- Easy mounting - bracket included
- Variable Speed models for
  - adjusting dose rate
- LED indication on variable speed models
- Reliable & accurate dosing
- Weatherproof - can be mounted outside (IP65)

## Operation

When the pump is powered, the roller assembly rotates, and in doing so, pinches the tube between the rollers and the pump body. Any air, or liquid inside the squeeze tube between the rollers moves along in a clockwise fashion. This action sucks the chemical up, through the squeeze tube, and out through the discharge tubing.

The rotor assemblies of the PE series are fixed speed, achieving a constant dose rate.

The PR series have a trim potentiometer, which when adjusted, varies the speed of the rotor assembly. This achieves a variable dose rate.

Furthermore, the PR series have a green LED indicating when the pump is powered.

All pumps are supplied with foot valve, suction tubing, discharge tubing and injection valve.

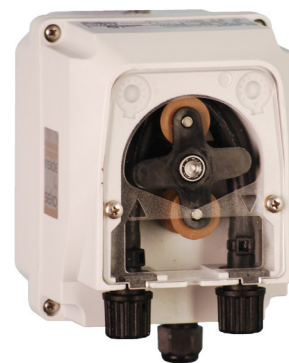

SEKO PE-1.3-FP-T



SEKO PR-1-FP

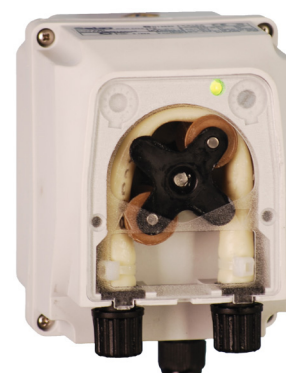

SEKO PR-4

## Dimensional Drawings

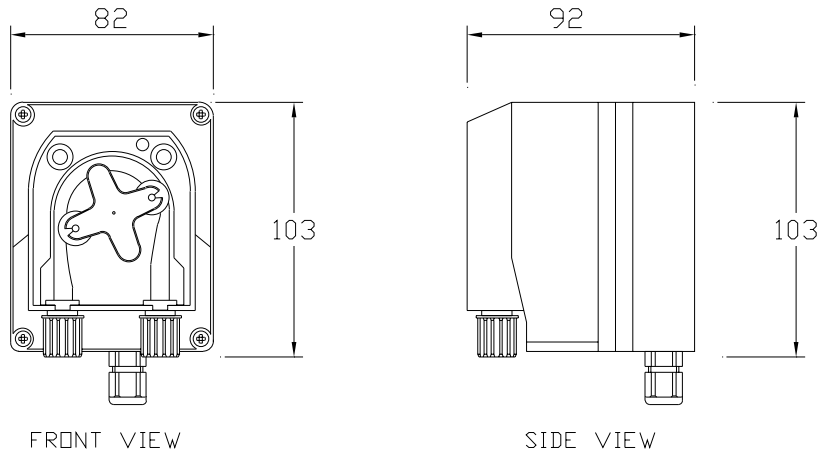

SEKO PE & PR Pumps

## Recommended Spare Parts

Ordering Code	Description
SP-SK-01A-BK	SEKO PE-0.4, PR-1 & PE-1.3 Squeeze tube (EPDM pre-greased with connectors)
SP-SK-01B	SEKO PE-5, PR-4 & PR-7 Santoprene Squeeze tube (pre-greased with connectors)
SP-SK-03A	SEKO Injection valve for PE-0.4, PR-1 & PE-1.3 pumps. 1/2" (or 1/4") BSP PP body, glass ball, Hastelloy C276 spring, Viton seal, for 6x4mm tube
SP-SK-03	SEKO Injection valve for PE-5, PR-4 & PR-7 pumps. 3/8" BSP PP body, Viton lip valve (ie duck-bill), to suit 6x4 Tubing
SP-SK-06	SEKO Roller assembly (black chassis, brown rollers) for PE-1.3, PE-0.4, PR-1 & PR-4 pumps incorporating black EPDM squeeze tube, Roller diameter 11.8mm
SP-SK-06A	SEKO Roller assembly (black chassis, brown rollers) for PE-0.4, PE-1.3 & PR-1 SEKO peristaltic pumps (with small Santoprene squeeze tube) & PP-1 (with small Sekobril squeeze tube). Roller diameter 12.2mm
SP-SK-06C	SEKO Roller assembly (black chassis, brown rollers) for PE-5.0 & PR-7 (with large Santoprene squeeze tube). Roller diameter 11.3mm
Available on request:	Black PE & Natural PVC 6x4mm tubing

## How to Order

Ordering Code → **SEKO P E - 1.3 - FP - T**

Dosing Pumps Included	
<b>E</b>	Fixed Pump Dosing Speed
<b>R</b>	Variable Pump Dosing Speed

Dose Rate	
<b>0.4</b>	0.4 Litres per hour fixed
<b>1</b>	0.3 to 1 Litre per hour adjustable
<b>1.3</b>	1.3 Litres per hour fixed
<b>4</b>	1.5 to 4 Litres per hour adjustable
<b>5</b>	5 Litres per hour fixed
<b>7</b>	3 to 7 Litres per hour adjustable

Transaxle Bearing / Wiring Connection	
<b>None</b>	No Face-plate bearing / Fly leads
<b>T</b>	Face-plate bearing / Fly leads
<b>PLUG</b>	3 Pin Plug attached (Face-plate bearing supplied with PE-1.3 pump only)

Squeeze Tube	
<b>None</b>	Santoprene Squeeze Tube included with Duck-bill injection valve
<b>FP</b>	EPDM Squeeze Tube included with Spring-loaded injection valve

## Specifications

### Accessories Incl.

	GENERAL
Suction Tubing	Soft PVC Natural 6x4 tube (2m roll)
Discharge Tubing	Hard PE Black 6x4 tube (2m roll)
Foot Valve	PVC & PP

### Physical

Electrical	220-240 VAC, 50/60Hz
Mounting	Wall
Housing Material	PP
Rating	IP65
Colour	Natural Grey or Blue
Dimensions	103mm (h) x 82mm (w) x 92mm (d)

### Capacity / Materials

	PE-0.4-FP	PE-1.3-FP-T	PE-5
Dose Rate	0.4 l/hr	1.3 l/hr	5.0 l/hr
Max Pressure	2.7 Bar (270 kPa)	2.7 Bar (270 kPa)	1.5 Bar (150 kPa)
Injection Valve	Viton Seal with PP Body, 0.3 Bar Crack pressure, Spring Loaded	Viton Seal with PP Body, 0.3 Bar Crack pressure, Spring Loaded	Duck-bill with Viton Seal, 3/8" BSP
Squeeze Tube	EPDM Pre-greased	EPDM Pre-greased	Santoprene Pre-greased
Viscosity Rating	400-500 cps	400-500 cps	400-500 cps

### Capacity / Materials

	PR-1-FP	PR-4	PR-7
Dose Rate	0.3 - 1.0 l/hr	1.5 - 4.0 l/hr	3.0 - 7.0 l/hr
Max Pressure	2.7 Bar (270 kPa)	1.5 Bar (150 kPa)	
Injection Valve	Viton Seal with PP Body, 0.3 Bar Crack pressure, Spring Loaded	Duck-bill with Viton Seal, 3/8" BSP	
Squeeze Tube	EPDM Pre-greased	Santoprene Pre-greased	
Viscosity Rating	400-500 cps	400-500 cps	