



# Controllers / Instruments

## Cyclical Dosing Controllers

Ordering Code	Description
AT200-WP1	Time based dosing/blowdown controller (continuous cycle of active period followed by idle period, repeated) - Internal connections for wiring in optional pump or solenoid valve
AT200-WP1/1S	AT200-WP1 with GPO socket for plugging in optional pump or solenoid valve
AT200-WP1-PE-1.3	AT200-WP1 mounted with SEKO PE-1.3 peristaltic dosing pump

## Description

The AT200 control packages are all designed to cycle a process on and off, rather than have it active all the time. A typical example is to dose a pump on a cycle or activate a solenoid valve on a cycle.

In the AT200-WP1 series, on power-up the pump/valve goes into an active state (typically seconds or minutes), where the pump/valve operates, followed by an idle state for a time period (typically minutes or hours). This cycle repeats until the unit is powered down.

## Features & Benefits

- Easy to set up & program
- Separate ON & OFF time adjustments
- Separate time ranges for ON & OFF times
- ON & OFF times independently settable from 0.2 seconds to 4 hours
- Weatherproof - can be mounted outside

## Operation

Mounted on a vertical surface at eye level, the AT200 series controller performs its control functions to give complete peace-of-mind water treatment.

### AT200-WP1:

The AT200 timer starts timing as soon as mains power is applied.

When the AT200-WP1 is powered, a DOSING (or BLEED) time commences. Once the DOSING (or BLEED) time is complete, an IDLE time commences. During the DOSING (or BLEED) time, the pump is dosing (or the solenoid valve is energised). Once, the IDLE time is complete, the cycle starts again with another DOSING (or BLEED) time.

After experimentation, the adjusted time settings will provide sufficient dosing ( or bleed) to maintain the correct chemical concentration ( or to keep the TDS at a desirable level).

The diagram below illustrates this:

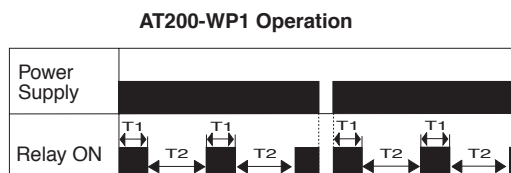

T1 = Time set for DOSING (or BLEED) time  
T2 = Time set for IDLE time



AT200-WP1



AT200-WP1/1S



AT200-WP1-PE-1.3

## Dimensional Drawings

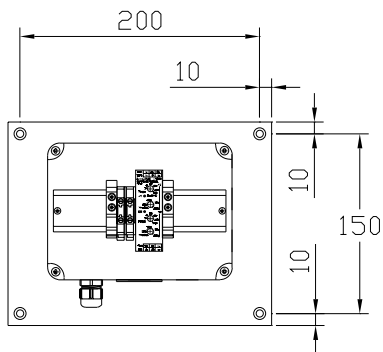

AT200-WP1, AT200-WP1/1S

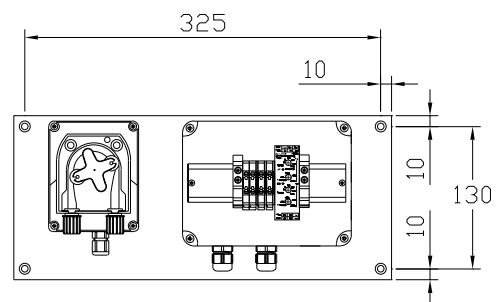

AT200-WP1-PE-1.3

Note: Mounting holes 6mm diameter, countersunk

## Specifications

	AT200-WP1	AT200-WP1/1S	AT200-WP1-PE-1.3
<b>Controller Function</b>			
Variable Measured	Time		
Range	ON/OFF cycle: 0.2s - 4hr each (independently set)		
Control Function	Repeated ON/OFF Cycle, ie. Dose time followed by Idle time		
Device Controlled	Switches 240VAC internally to wire in optional dosing pump or valve	Switches 240VAC GPO for plugging in optional dosing pump	Activates peristaltic pump (1.3l/hr, 3bar)
<b>Electrical</b>			
Power Supply	220-240 VAC, 50/60Hz		
Control Relay Output	240VAC switched		
Relay Rating	5A/250VAC, resistive load		
<b>Physical</b>			
Protection	IP55 (weatherproof)		IP55 + IP65 (weatherproof)
Panel Dimensions	170 (h) x 220 (w) mm		150 (h) x 345 (w) mm
Packaged dimensions	350mm (l) x 350mm (w) x 200mm (h)		
Packaged weight	3 kg		5 kg